

Southwest United Fire Districts – CPAT Testing Service

Directions

Important Please Note—Our Mailing address is 7045 Joliet Road. This address is for MAILING PURPOSES ONLY. We do not have an entrance to our building located on Joliet Road.

The Apprenticeship Office and Training Facility is located on a private road named Roofers Road. This private road, Roofers Road, is currently not listed on any map or online driving directions search engine.

The entrance to Roofers Road is approximately 7060 South Wolf Road.

You can use this address 7060 Wolf Road, La Grange, Illinois, 60525 in most online driving directions search engines. But please remember you MUST turn onto Roofers Road and proceed up Roofers Road as far as possible (1 block) to the apprenticeship office and training facility.

General Direction Info

From Chicago—I55 south to LaGrange Rd. North. LaGrange Rd. north to Joliet Rd. Turn left on Joliet going west. Joliet Rd. west to Wolf Rd. Turn left on Wolf Rd. going south, immediately after overpass turn right on Roofers Rd. and proceed up Roofers Rd. as far as possible to the office entrance.

From South Suburbs—I294 north to the I55 South / Wolf Rd. exit. Exit on Wolf Rd. At the bottom of exit ramp turn left going south then immediately after overpass turn right onto Roofers Rd. and proceed up Roofers Rd. as far as possible to the office entrance.

From the North Suburbs—I294 south to the I55 exit. Pay toll and exit on the Joliet Rd. East exit. Continue on Joliet Rd. to Wolf Rd. Turn right on Wolf Rd going south, immediately after overpass turn right on Roofers Rd. and proceed up Roofers Rd. as far as possible to the office entrance.

From Joliet / Southwest Suburbs—I55 north to Joliet Rd. East (exit is on the left side of expressway). Joliet east to Wolf Rd. Turn right on Wolf Rd. going south, immediately after overpass turn right on Roofers Rd. and proceed up Roofers Rd. as far as possible to the office entrance.

From Aurora—I88 east to I294 South. Take I294 south to I55 exit pay toll and exit on the Joliet Rd. East exit. Continue on Joliet Rd. to Wolf Rd. Turn right on Wolf Rd. going south, immediately after overpass turn right on Roofers Rd. and proceed up Roofers Rd. as far as possible to the office entrance.

From Rockford—I90 east to I294 South. Take I294 south to I55 exit pay toll and exit on the Joliet Rd. East exit. Continue on Joliet Rd. to Wolf Rd. Turn right on Wolf Rd. going south, immediately after overpass turn right on Roofers Rd. and proceed up Roofers Rd. as far as possible to the office entrance.

From Kankakee—I57 north to I80 East exit. I80 east to I294 North exit. I294 north to the I55 South / Wolf Rd. exit. Exit on Wolf Rd. At the bottom of the exit ramp turn left going south, immediately after overpass turn right onto Roofers Rd. Proceed up Roofers Rd. as far as possible to the office entrance.

From Ottawa—I80 East to I55 North to Joliet Rd. East (exit is on the left side of the expressway). Joliet Rd. East to Wolf Rd. Turn right on Wolf Rd. going south, immediately after overpass turn right on Roofers Rd. and proceed up Roofers Rd. as far as possible to the office entrance.

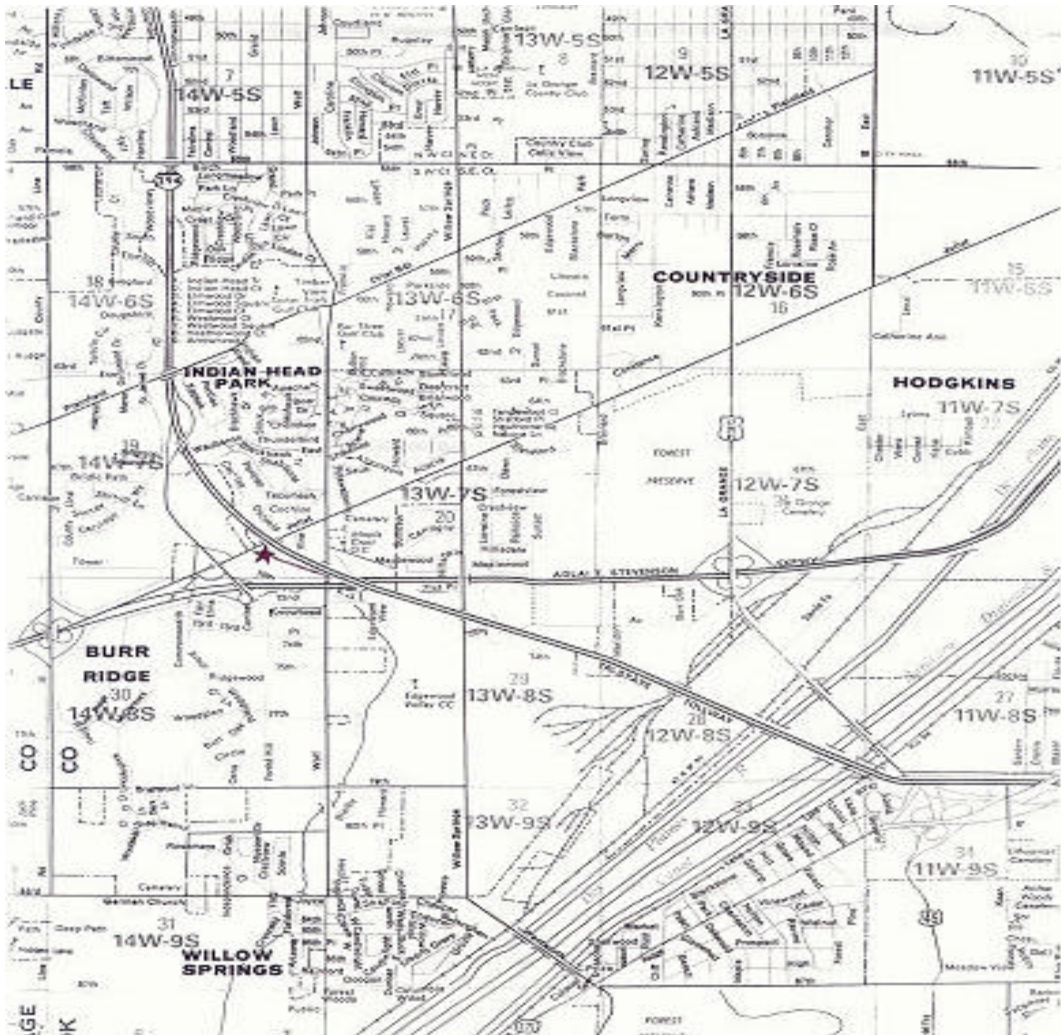

Southwest United Fire Districts
CPAT Testing Center
Held at:
Chicago Roofers Joint Apprenticeship & Training Program
7045 Joliet Road
Indian Head Park, Illinois 60525
Office: (708)246-4488
Fax: (708)246-5908